

# XLERATOR® FILTER RETROFIT KIT OWNER'S MANUAL

## 40525 HEPA FILTER RETROFIT KIT



**WARNING: TO REDUCE THE RISK OF ELECTRIC SHOCK, FIRE & PERSONAL INJURY, INSTALLATION MUST BE PERFORMED BY QUALIFIED ELECTRICAL SERVICE PERSONNEL. DISCONNECT POWER TO THE DRYER BEFORE INSTALLING THE FILTER KIT. IMPORTANT: KIT ONLY TO BE INSTALLED ON XLERATOR DRYERS PRODUCED AFTER 1/1/2009 SERIAL #370656 AND HIGHER, AND WITH CONTROLS #40102 OR 40103.**

## INSTALLATION INSTRUCTIONS

### TOOLS NEEDED

- Phillips Head Screwdriver (Not Included)
- Tamper-Proof Hex Wrench (Included)

### MODELS COVERED

XL- followed by W, C, GR, BW, BSP, SB, SPO, SS, SW, SC, SSP, SI or SP, followed by V or 8 or X, and or H, and or -ECO

**Disconnect power to the dryer before installing the Filter Kit. Remove the cover of the dryer using the special wrench (F) supplied in the Filter Hardware Kit.**

The HEPA Retrofit Kit comes packaged with parts (A, B, G) fitted together. They can easily be pulled apart to begin assembling.

Parts (C, D, E, F, H & I) are packaged in an envelope labeled "FILTER HARDWARE KIT."

REF	PART	QTY
A	Filter Adapter	1
B	HEPA Filter	1
C	Control Adapter Plate (used with 40102 control only)	1
D	#6-32 Machine Screws	3
E	Heater Extension Wire (used with 40102 control only)	1
F	Tamper-Proof Hex Wrench	1
G	Pre-Filter	1
H	Label for Filter Adapter (used with 40102 control only)	1
I	Label for Dryer Cover	1

Verify your kit has the following parts:

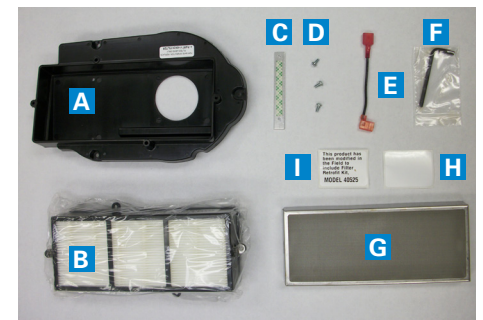

Figure 1

**To install into dryer with control assembly 40102 - follow steps 1 through 13, otherwise proceed to page 5 for installation into dryer with control assembly 40103.**

**1.** Find and disconnect the heater wire from the control assembly (connected in terminal position labeled "4" on the sticker). The heater wire is black, red or brown depending on dryer voltage and can be traced back to the heater (**Figure 2A**). Attach the heater extension wire (E) to the wire by inserting the female flag terminal into the male connector on the extension wire. Connect the other end of the extension wire back to the Control (**Figure 2B**).

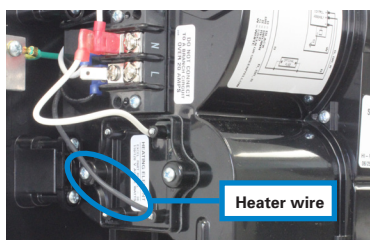

Figure 2A

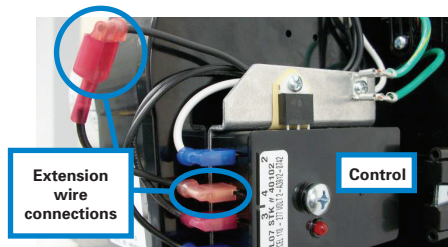

Figure 2B

**2.** Remove the two (2) screws that fasten the control bracket onto the dryer and **save them for Step 12**. Remove the four wires from the white retaining clip while keeping them attached to the Control (**Figure 3**).

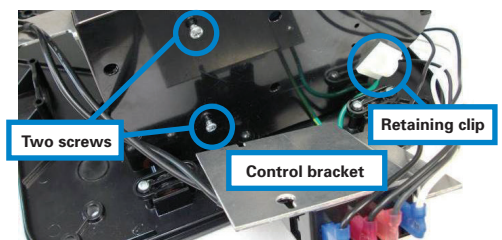

Figure 3

3. Remove the **three (3)** screws from the air inlet cover and pull it off the dryer. **Save all three of these screws for later use in Step 11. (Figure 4)**

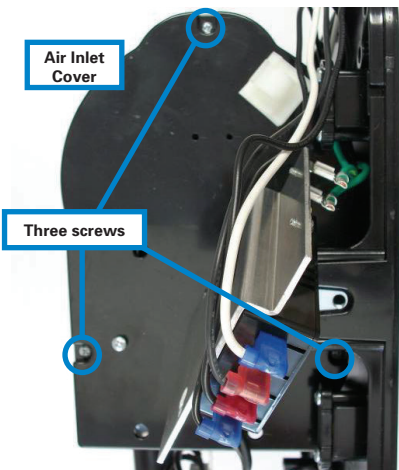

Figure 4

4. Two of the power wires coming from the terminal block must be adjusted in order to reach the Control properly. The **white** wire going from the terminal block to the Control must be unplugged and moved from behind the housing retainer. Simply unplug it from the terminal block, route it from under the housing retainer, reroute it above the housing retainer, and plug it back in so that the flag connector is oriented as illustrated in **Figure 7**. Additionally, be sure the flag connector on the **black** wire going from the terminal block to the Control is oriented the same as the repositioned white wire. Reference **Figures 5 and 6** to see how the black wire should be oriented.

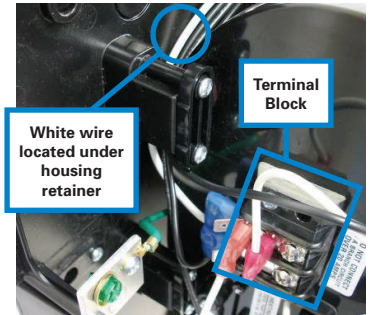

Figure 5

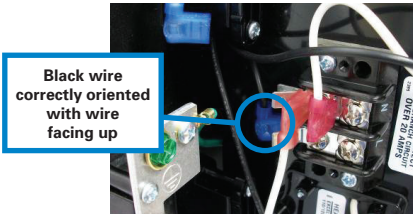

Figure 6

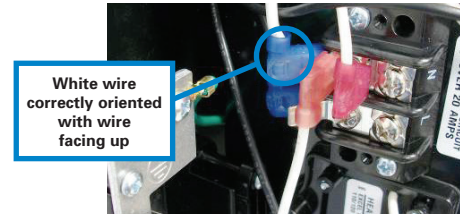

Figure 7

**IMPORTANT NOTE: AFTER STEP 4, VERIFY THAT THE WHITE NEUTRAL WIRE AND THE BLACK POWER WIRE ARE CONNECTED IN THE CORRECT LOCATIONS ON THE TERMINAL BLOCK ACCORDING TO THE WIRING SCHEMATIC OF THE DRYER DEPICTED ON THE INSIDE OF THE DRYER OR DRYER COVER.**

5. Remove the **two (2)** screws and one plastic housing retainer holding down the foot of the dryer. Refer to **Figure 8**.

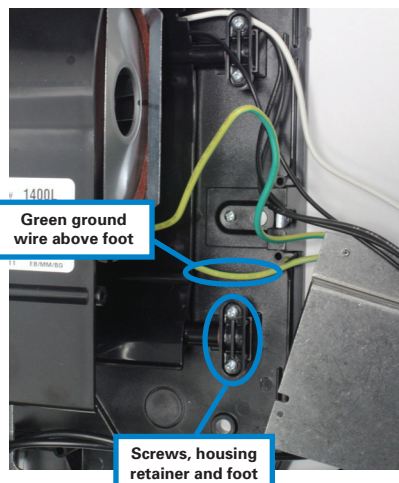

Figure 8

6. With the retainer removed, pull the corner of the dryer away from the baseplate enough to pull the green ground wire underneath and below the dryer foot. See **Figure 9**.

**DO NOT MOVE THE GROUND WIRE CONNECTED TO THE MOTOR. MOVE ONLY THE GROUND WIRE WHICH TRAVELS UNDERNEATH THE DRYER.**

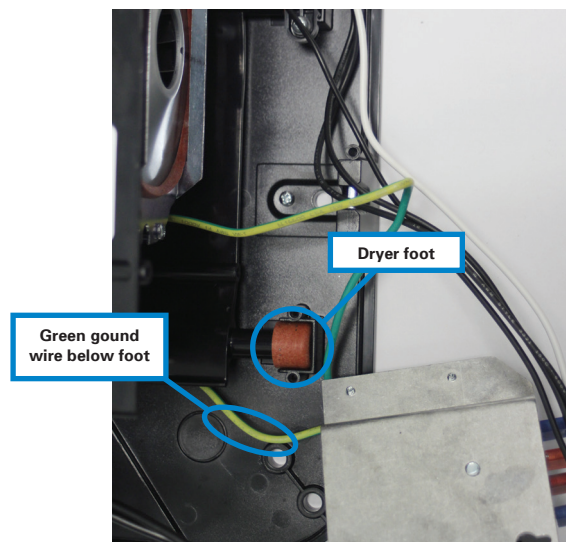

Figure 9



7. Reinstall the **two (2)** screws and plastic housing retainer onto the foot of the dryer removed in Step 5. Make sure that the ribs on the housing retainer are facing outward (facing away from the dryer - **Figure 10**).

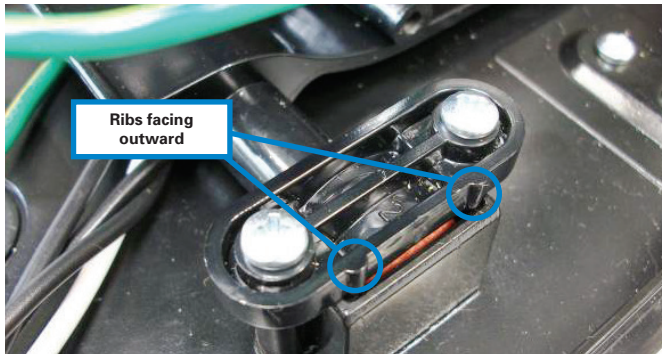

Figure 10

8. Locate the Control Adapter Plate (C) and peel the tape backing off. Place it over the **slotted and elongated holes** on the bracket so that the hole that is  $\frac{1}{2}$ " from the edge of the Control Adapter Plate (C) is placed closest to the wire connections (**Figure 11**). Press the Adapter plate firmly into place flush against the Control.

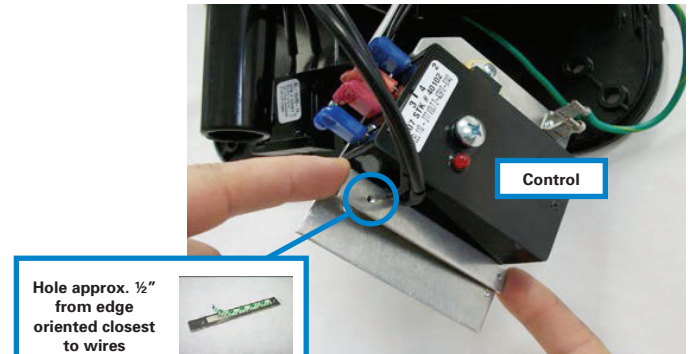

Figure 11

9. Rotate the Control **clockwise** as shown in **Figures 12A & 12B**. Rotating the Control this way will properly position the wires without having to disconnect and re-connect them. See **Figure 15** for wire orientation.

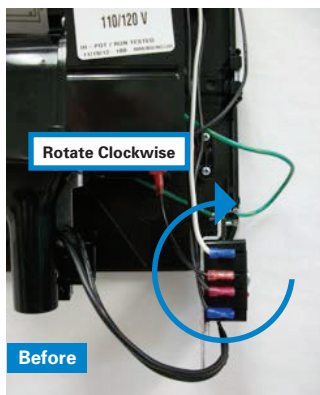

Figure 12A

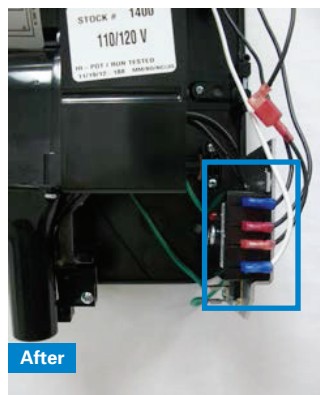

Figure 12B

10. Set HEPA Adapter as shown **Figure 13A** and locate the 2 holes to be covered by the Label for Filter Adapter Item H. Apply Label as shown in **Figure 13B** to cover the 2 holes.



Figure 13A



Figure 13B

11. To attach the Control to the Filter Adapter, find the Filter Adapter (A) as shown in **Figure 14**. Align and thread the #6-32 screws (D) from the inside of the Filter Adapter through the Control Adapter Plate (**Figure 15**). Clip the 4 control wires into the white plastic retaining clip on the backside of the Filter Adapter.

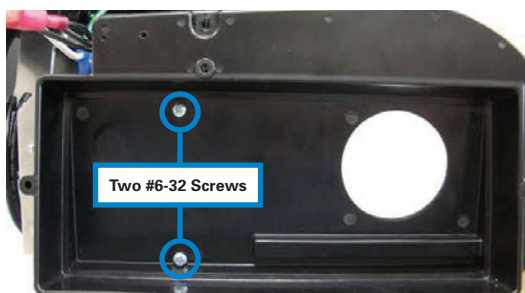

Figure 14

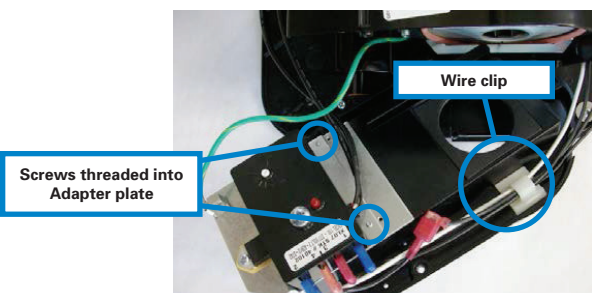

Figure 15

**12.** Attach the Filter Adapter with Control in the spot where the air inlet cover was removed, using the **three (3)** screws previously removed in Step 3. Make sure to route the wires through the Adapter slot so that they are not pinched (especially in the areas indicated in **Figure 16**). It may be necessary to adjust the position of the Adapter (A) until it is flush with the dryer housing. The Adapter will not be positioned flush to the dryer until the screws are tightened. The foam seal on the back of the Filter Adapter will compress against the casing of the motor.

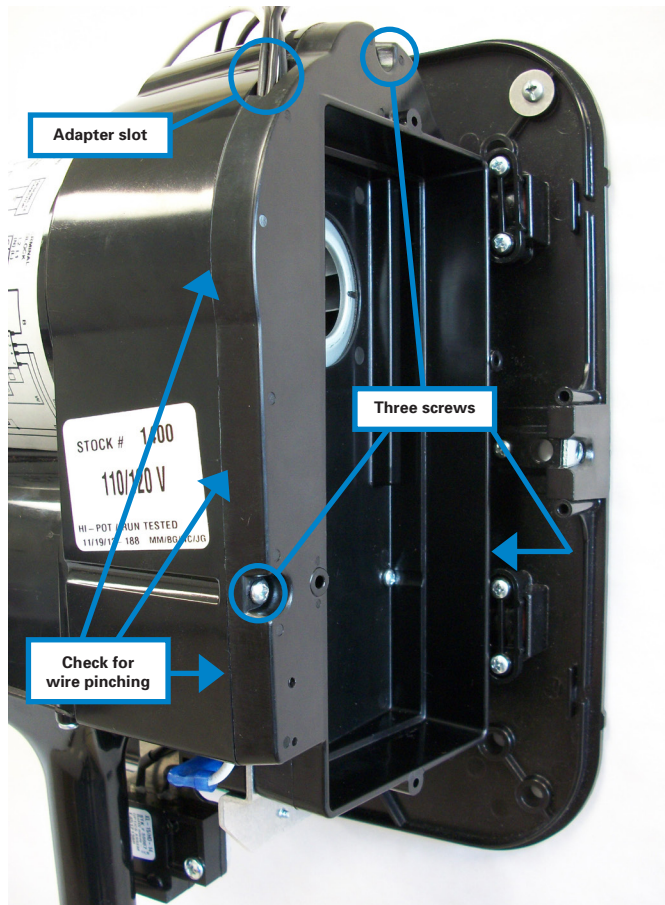

Figure 16

**13.** Take the HEPA Filter (B) out of the clear sealed plastic wrap and insert the Filter into the Filter Adapter. **DO NOT touch the white filter media, as this can result in reduced performance and efficiency.** The side with the foam gasket around the perimeter of the filter should be placed into the Filter Adapter first. Position the filter so that the label is facing away from the wall as shown in **Figure 18**. Fasten the filter to the Filter Adapter with the two screws previously removed in Step 2 (**Figure 17**).

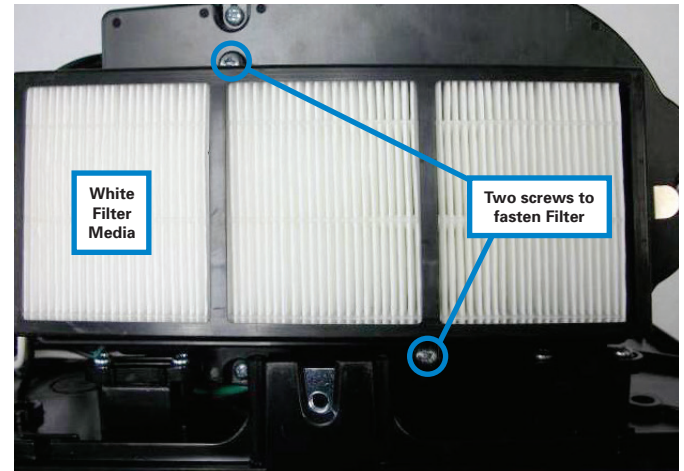

Figure 17

**14.** Push on the corners of the metal Pre-Filter (G) so that it fully clips into place. The clips will fall into square cutouts in the metal frame of the Pre-Filter. Place the Pre-Filter so that the label is facing the same direction as the filter label. Installation is now complete. Put the dryer cover on, carefully avoiding pinching any wires, then restore power to check for proper function. After conversion is completed affix retrofit label (I) to the outside of cover on the lower right side.



Figure 18



1. Find and disconnect the Control Harness Connector on your dryer from the control by squeezing the tab while unplugging. Unclip harness wires from hold down clip and move harness to the left out of the way for the next steps. Remove and discard dryer Pre-filter. (Figure 1)

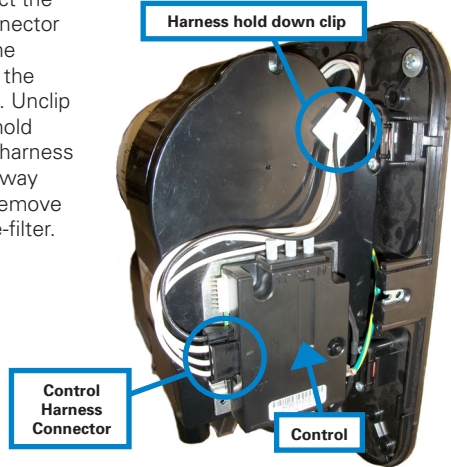

Figure 1

2. Loosen the two screws that fasten the control bracket onto the dryer and slide control with bracket off dryer. Remove screws and save them for Step 11. Locate and disconnect the Sensor by squeezing the tab while unplugging. Disconnect the green ground wire from the tab on the bracket. Place control off to the side for step 7 (Figure 2)

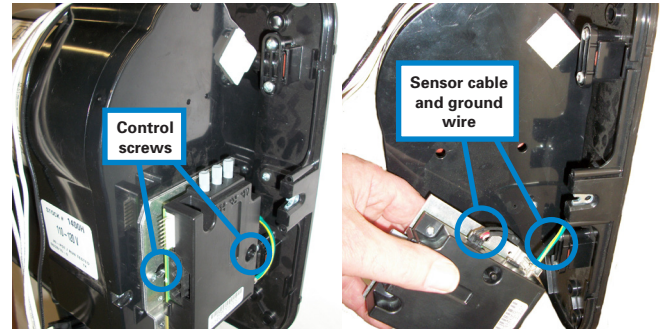

Figure 2

3. Remove the three (3) screws attaching the air inlet cover and remove it from the dryer. Save all three of these screws for later use in Step 10. (Figure 3)

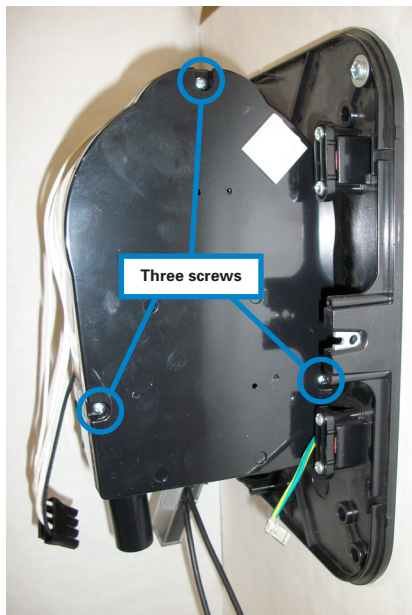

Figure 3

4. Remove the two (2) screws and one plastic housing retainer holding down the foot of the dryer. (Figure 4)

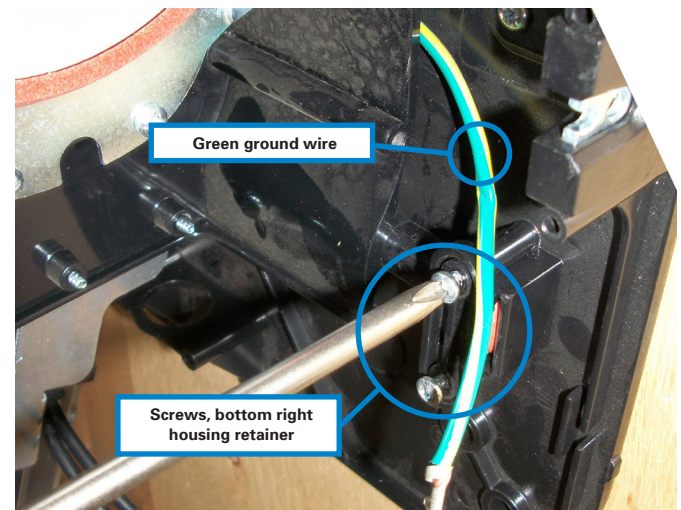

Figure 4

5. With the retainer removed, pull the corner of the dryer out away from the base plate enough to pull the green ground wire underneath the dryer foot toward the bottom of the dryer. (Figure 5)

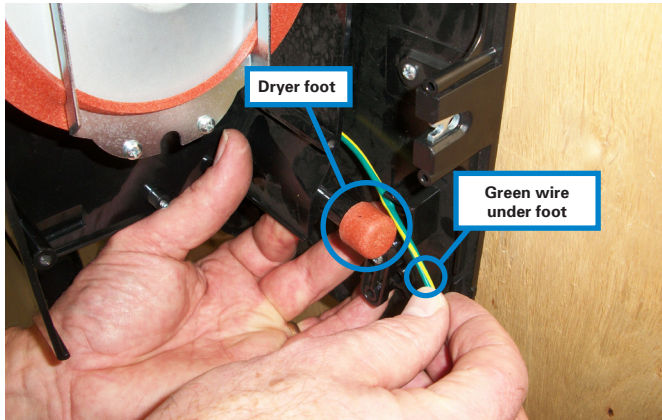

Figure 5

6. Reinstall the two (2) screws and plastic housing retainer onto the foot of the dryer. Make sure that the ribs on the housing retainer is facing outward or facing away from the dryer. (Figure 6)

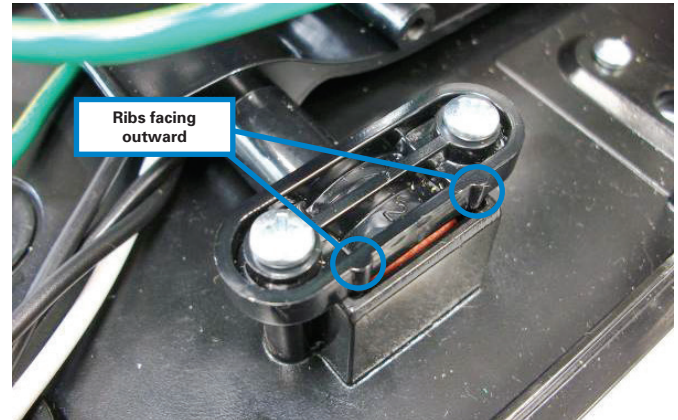

Figure 6

7. Arrange control (previously removed) and the HEPA Filter Adapter as shown (Figure. 7)

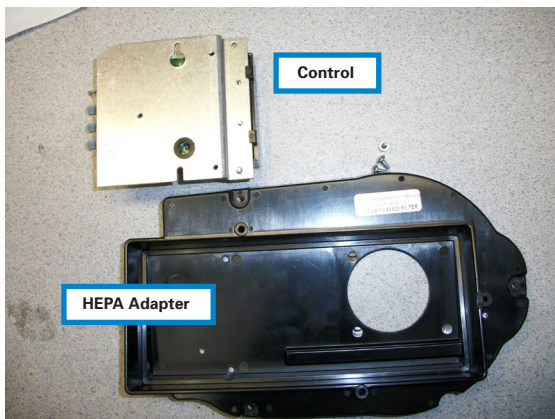

Figure 7

8. Set HEPA Adapter on top of Control and align the three mounting holes in the Adapter to three matching holes on the control bracket. Use the 3 enclosed 6-32 self-tapping screws to attach the Control to the HEPA Adapter. (Figure 8)

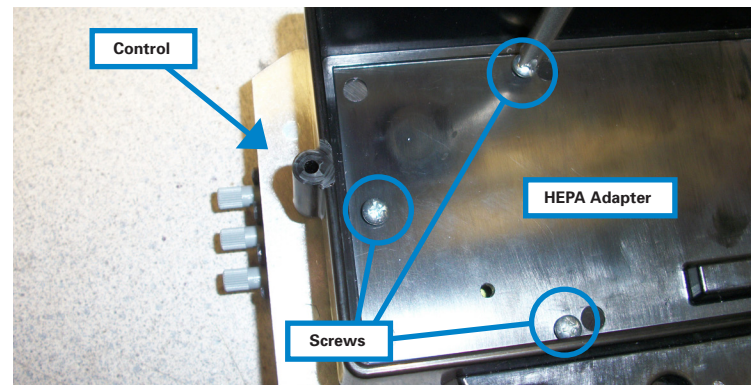

Figure 8

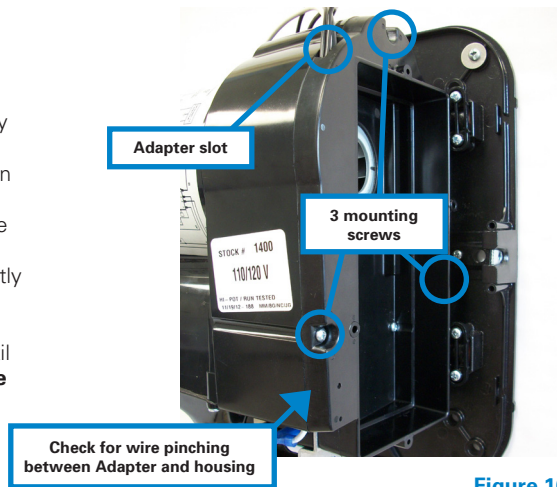

Figure 9

9. Attach Control Harness Connector to Control and route wires as shown in Figure 9. Make sure wires are installed under white clip on adapter. Connect green wire back on quick connect tab on bracket. Reconnect sensor to Control. (Figure 9)



**10.** Attach the Filter Adapter (control assembly is now on inside) in the location where the Air Inlet Cover was removed, using the three screws previously removed in step 3. Make sure to route the wires through the slot in the Adapter so that they are not pinched. Also check to make sure wires are routed to clear internal boss. It may be necessary to lightly manipulate the Adapter around until it fits properly. The Adapter will not fully seat to the dryer until the screws are tightened. **(Figure 10)**



**Figure 10**

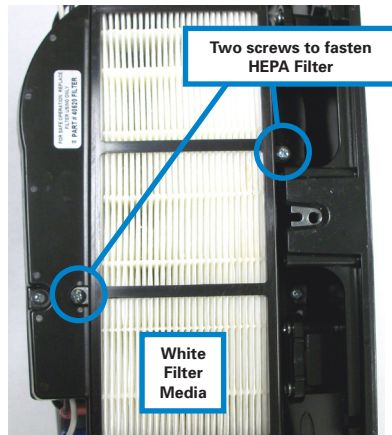
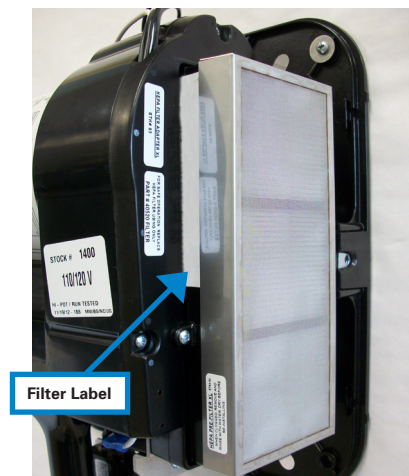

**Figure 11**

**11.** Take the HEPA Filter (B) out of the clear sealed plastic wrap and insert the HEPA Filter as shown into the Filter Adapter. DO NOT push on the white filter media. This can result in reduced performance and efficiency. The side with the foam gasket around the perimeter of the HEPA Filter should be placed into the Filter Adapter first. Position the filter so that the filter label is facing away from the wall. Fasten the HEPA Filter to the Filter Adapter with the two control screws previously removed in Step 2. **(Figure 11)**

**12.** Install the HEPA Pre-Filter by pushing on the corners of the metal pre-filter (E) so that it fully clips into place. The clips will fall into square cutouts in the metal frame of the pre-filter. Place the pre-filter so that the label is facing the same direction as the HEPA Filter Label. Installation is now complete. Replace dryer cover, carefully avoiding pinching any wires, then restore power to check for proper function. **(Figure 12)**

**Affix dryer label (I) to outside of cover, on the lower right side.**



**Figure 12**



**WARNING: TO REDUCE THE RISK OF ELECTRIC SHOCK, FIRE & PERSONAL INJURY, CLEANING MUST BE PERFORMED BY QUALIFIED ELECTRICAL SERVICE PERSONNEL. DISCONNECT POWER TO THE DRYER BEFORE CLEANING THE FILTER KIT. IT IS RECOMMENDED THAT YOU REFER TO THE CDC FOR HANDLING GUIDELINES WHEN CLEANING THE PRE-FILTER OR REPLACING THE HEPA FILTER IF EITHER FILTER MAY HAVE BEEN EXPOSED TO A CONTAGION.**

## PRE-FILTER

It is generally recommended that the Pre-Filter be inspected and cleaned as required at the rate of four times per year. If the dryers are installed in an environment that contains excessive lint, dust or other particles in the air, then it is recommended to begin with a monthly inspection and cleaning. If the Pre-Filter seems excessively dirty (i.e., lint buildup, debris), increase the rate of cleaning accordingly. You may decrease the rate of cleaning if no debris is found during the regular cleaning schedule.

### Cleaning the Pre-Filter

1. Disconnect the power to the dryer.
2. Remove the cover of the dryer with Tamperproof Wrench (provided with dryer and/or Filter).
3. Unclip the metal Pre-Filter from the HEPA Filter.
4. Rinse the Pre-Filter with clean water and let completely air dry (this usually only takes a few minutes). You may use a paper towel or cloth to clean the metal edge of the Pre-Filter, but avoid coming into contact with the mesh Pre-Filter, so that no lint or debris is left behind on the Pre-Filter.
5. Once the Pre-Filter has dried completely, re-install it onto the HEPA Filter.

**DO NOT REMOVE THE HEPA FILTER OR ALLOW IT TO COME INTO CONTACT WITH WATER**

## HEPA FILTER MAINTENANCE

The key to the life of the HEPA Filter is the cleanliness of the Pre-Filter. Whenever the Pre-Filter is removed and cleaned, the HEPA Filter should be inspected for any excessive debris buildup. A slight discoloration over time is normal and not an indication of failure. The Manufacturer recommends replacing the HEPA Filter every 6-12 months, depending on usage.

### DO NOT CLEAN THE HEPA FILTER

## TROUBLESHOOTING INSTRUCTIONS

If your dryer has a HEPA Filter and has a reduced airflow or stops, an error code will flash in the sensor indicating it is time to clean your Pre-Filter:

1. Inspect the Pre-Filter for lint buildup. Clean by removing Pre-Filter and rinse in warm water then dry Pre-Filter before reinstalling.
2. If the Pre-Filter is clean, check HEPA Filter for signs of clogging. Replace Filter if needed.

**Please refer to the XLERATOR Manual for additional troubleshooting tips with respect to your dryer.**





**WARNING: TO REDUCE THE RISK OF ELECTRIC SHOCK, FIRE & PERSONAL INJURY, INSTALLATION MUST BE PERFORMED BY QUALIFIED ELECTRICAL SERVICE PERSONNEL. DISCONNECT POWER TO THE DRYER BEFORE INSTALLING THE FILTER.**

## TOOLS NEEDED

- Phillips Head Screwdriver (Not Included)
- Tamper-Proof Hex Wrench (Included)

1. Disconnect the power to the dryer.
2. Remove the cover of the dryer with the Tamperproof Wrench provided.
3. Remove Pre-Filter from Filter and save for reuse. See **Figure 1**.
4. Remove and save **two (2) screws** securing Filter to blower housing and remove Filter as shown. See **Figures 1 and 2**.
5. Take the Filter out of the clear sealed plastic wrap and insert the Filter into the Filter Adapter. DO NOT push on the white filter media. This can damage the filter media. The side with the foam gasket around the perimeter of the Filter should enter into the Filter Adapter first. Fasten the Filter to the Filter Adapter with the **two (2) screws** which were removed and saved in Step 2. See **Figures 2 and 3**.
6. Snap the Pre-Filter into place. Do this by simply pushing the Pre-Filter over the Filter so that the metal spring clips snap into the square cutout on each side of the Pre-Filter. The installation is now complete. Reinstall the cover to the hand dryer and restore power.

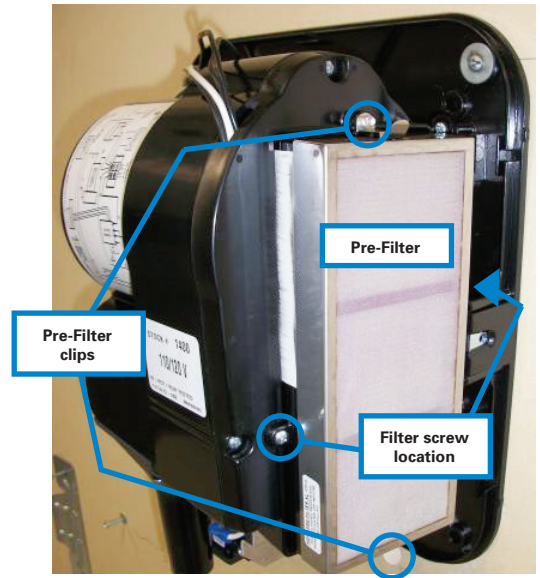

Figure 1



Figure 2



Figure 3

1. This product is warranted to be free from manufacturing defects only for a period of one year from the date of shipment from the Manufacturer's factory at 357 Chestnut St., East Longmeadow, Massachusetts 01028. This warranty explicitly excludes normal wear and tear on the filter or Pre-Filter, as well as faulty installation, accident, misuse, or vandalism.
2. Any implied warranties of merchantability or fitness for a particular purpose are hereby limited to the duration of the express written warranty contained herein. There are no other warranties and remedies except as contained herein. This warranty shall inure to the benefit of the owners, Successors and Assigns.

In the event of a breach of the warranty described above, the owner may notify the Manufacturer by telephone or in writing of the defect and, within a reasonable time, the Manufacturer shall send a suitable replacement part to remedy said defect, and the owner shall be charged for said part at the current price level. The owner may return the defective part to the Manufacturer, postage prepaid by the owner, along with the serial number of the defective product and the Manufacturer will then issue to the owner a full credit for the repair part, including outgoing postage to a Continental U.S. destination.

